

Established



1816

79.75 Acres of Standing Winter Barley Straw For Sale by Auction

On Behalf of Mr. R Moule
Afton Farm, Berry Pomeroy, Totnes, TQ9 6NJ

Wednesday 6th July 2022
Auction to commence at 12:00noon

At Newton Abbot Livestock Market,
Market Street, Newton Abbot, Devon, TQ12 2RL

For Further Information Please Contact
Russell Thomas on 01364 653017



Rendells - Ashburton
Stonepark, Ashburton, Devon. TQ13 7RH
T: 01364 653017
E: r.thomas@rendells.co.uk
www.rendells.co.uk

Conditions of Sale

- a) Purchase money and commission to be paid by the successful Purchaser to Messrs Rendells in full within 5 working days from confirmation of sale.
- b) Payment by cash, card, BACS or cheque only.
- c) Buyer's Premium is 5.0% of the purchase price plus VAT.
- d) Purchasers will be notified by the Vendor when fields have been combined and are ready for baling.
- e) No baled straw is to be stored on any of the headlands or grass margins and must be removed after baling.
- f) All straw (including bales) to be cleared within 14 days of notification.
- g) Purchaser not to cause damage to the land or property (including gates, hanging or latching posts) during baling and removal of straw and to pay compensation as assessed by Rendells for any damage done.
- h) The straw in each lot is at the purchaser's risk after notification has been given the field is ready for baling.
- i) No dogs are permitted on the property whilst viewing, baling or collecting the straw.
- j) The field sizes have been measured to the best of our knowledge, taking into account the field margins, however the sizes may vary slightly; if so Rendells hold no responsibility for this.
- k) Round Baling of straw may be available by negotiation through the vendor.
- l) All lots to be sold on a per acre basis.
- m) Viewing only with these particulars to hand during daylight hours.

Afton Farm Standing Straw Lots

Lot	OS No	Crop	Variety	Drilled Acres	Drilled Hectares
1	8723	Winter Barley	Orwell	4.00	1.62
	1217	Winter Barley	Orwell	12.50	5.06
	1329	Winter Barley	Orwell	8.50	3.44
	Lot 1 Total Area			25.00 Ac	10.12 Ha

2	0841	Winter Barley	Orwell	8.00	3.24
	1962	Winter Barley	Orwell	8.75	3.54
	2950	Winter Barley	Orwell	7.00	2.83
	Lot 2 Total Area			23.75 Ac	9.61 Ha

3	4453	Winter Barley	Valerie	9.00	3.64
	6259	Winter Barley	Valerie	8.00	3.24
	Lot 3 Total Area			17.00 Ac	6.88 Ha

4	8250	Winter Barley	Valerie	14.00	5.67
	Lot 4 Total Area			14.00 Ac	5.67 Ha

The crops have been treated with the following (as of 8th June 2022):
 Winter Barley: 2 fungicides, 1 growth rate and 1 Wild Oat Spray

Established



1816

**Property & Land
Sales**

The Letting Centre



**Chartered
Surveyors**

**Agricultural
Valuers**

Auctioneers

**Antique Saleroom
01364 653017**



**Newton Abbot
01626 353881**

**Totnes
01803 863888**

**Chagford
01647 432277**

**Ashburton
01364 654670**

www.rendells.co.uk



Rural Land Register
(RLR) Map

SBI - 107095023
Page 2 of 4

Legend

- Your RLR Parcel(s)
- SPS Permanent Ineligible Features
- Adjacent Parcel Boundary
- Unconfirmed Boundary

RLR Information

Sheet ID	Parcel ID	Total Area (ha)	SPS Recorded Eligible Area (ha)	English Region
				N
				N
				N
				N
				N
				N
				N
				N
				N
				N
				N
				N
				N
				N
				N
				N
				N
				N
				N
				N
				N
				N
				N
				N
				N
				N
				N
				N
				N
				N
				N
				N
				N
				N

Standing Straw for Sale by Auction
On behalf of Mr. R Moule
Afton Farm, Berry Pomeroy, Totnes, Devon. TQ9 6NJ
Wednesday 6th July 2022
Auction to commence at 12:00noon

For more information, please contact
Russell Thomas on 01364 653017 or r.thomas@rendells.co.uk

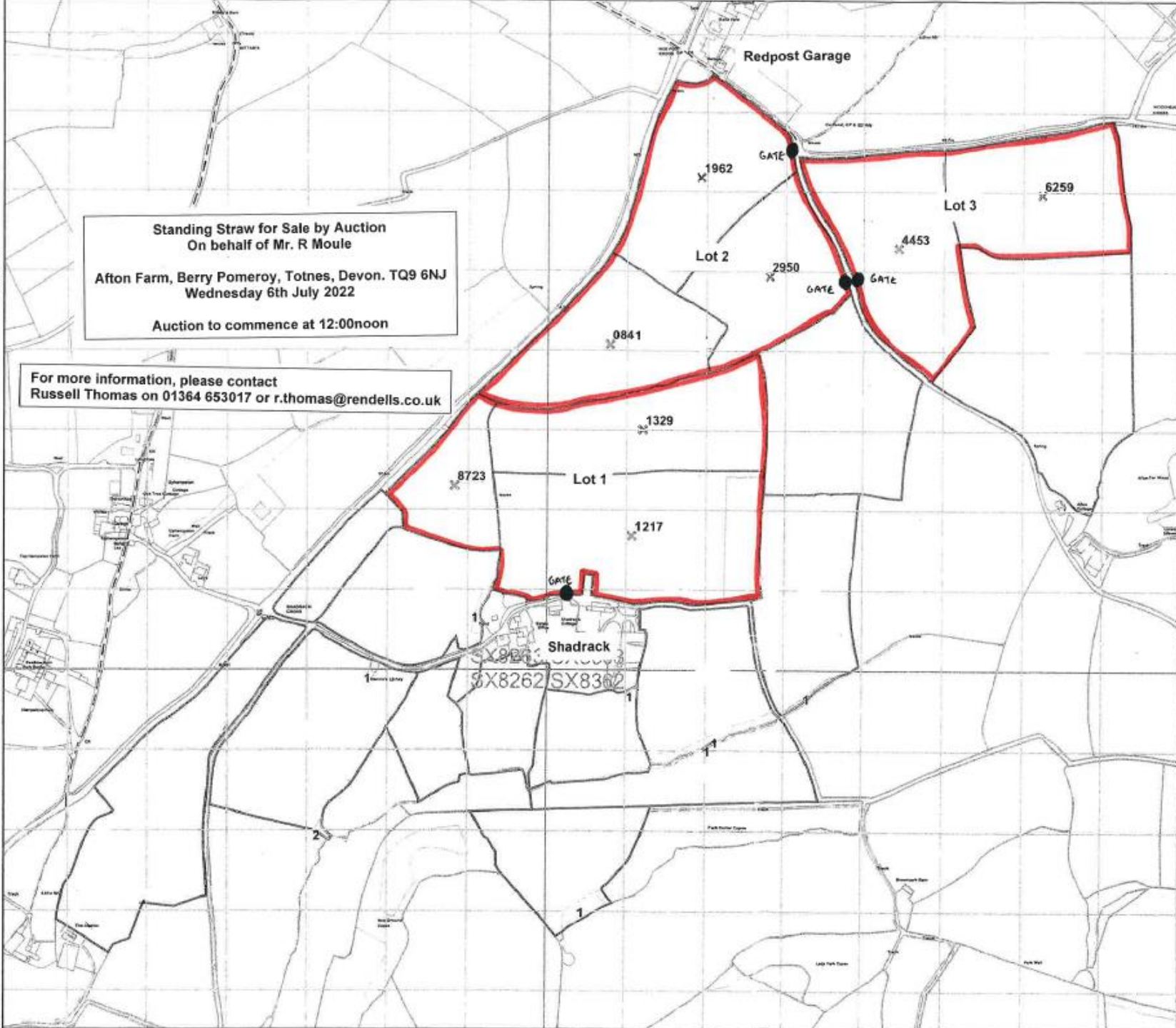

Scale - 1:5000

You are not permitted to copy, sub-license, distribute or sell any of this data to third parties in any form.
© Crown copyright and database right 2013. All rights reserved.
Ordnance Survey Licence number 100029155
Licensed for RPA for PGA through Next Perspectives™

Date: 20/03/2015

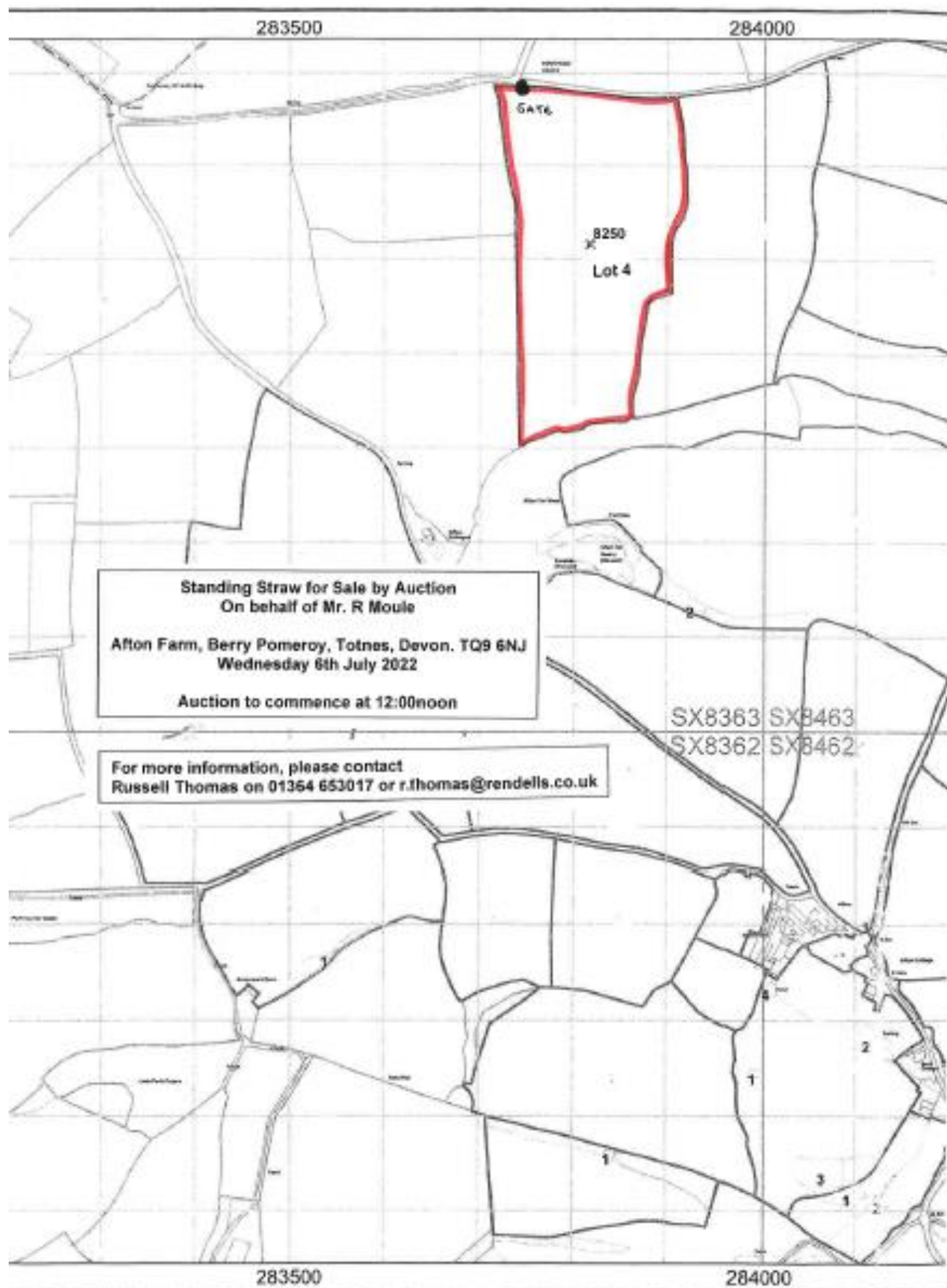

Standing Straw for Sale by Auction
On behalf of Mr. R Moule
Afton Farm, Berry Pomeroy, Totnes, Devon. TQ9 6NJ
Wednesday 6th July 2022
Auction to commence at 12:00noon

For more information, please contact
Russell Thomas on 01364 653017 or r.thomas@rendells.co.uk

SX8363 SX8463
SX8362 SX8462

Please return this sheet to us if you want to make a